



Call Before  
 You Dig!  
**811**

Rev #	Date	Description
Sta10 Project #:	23004	
Submittal:		Permit

**Bike Skills Area at Deane's Children's Park**  
 5701 Island Crest Way  
 Mercer Island, WA 98040

Design:	SEH
Drafting:	--
Checked:	SEH
Date:	6/28/23

**TESC and Site Demo Plan**

Sheet: **C1.0**

**Datum**  
 NAVD 88

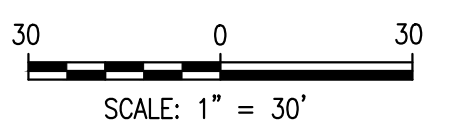
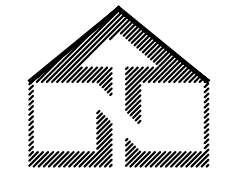

**Legend**

- CATCH BASIN PROTECTION
- STRAW WATTLE
- SILT FENCE
- SITE DISTURBANCE LIMITS

**Notes**

- SEE BELOW FOR TESC GENERAL NOTES AND SHEET C2.0 FOR GENERAL NOTES.
- MAINTAIN/RELOCATE TESC MEASURES AND PROVIDE ADDITIONAL TESC MEASURES AS REQUIRED TO STABILIZE EXPOSED SOILS, MINIMIZE SEDIMENT TRANSPORT ON SITE, AND MEET ALL SITE DISCHARGE AND PERMIT REQUIREMENTS. ADDITIONAL FACILITIES BEYOND THOSE INDICATED ON THIS PLAN MAY BE REQUIRED, AND IT IS THE CONTRACTOR'S RESPONSIBILITY TO DETERMINE AND PROVIDE ADDITIONAL MEASURES THAT ARE NECESSITATED DUE TO THEIR OPERATIONS AND SEQUENCING OF THE WORK. ALL TESC MEASURES SHALL BE REMOVED FOLLOWING SITE STABILIZATION WITH FINAL PAVING AND PLANTING.
- NOT ALL REQUIRED CB PROTECTION IS INDICATED ON THIS PLAN. INSTALL CB PROTECTION IN ALL EX CATCH BASINS TO REMAIN DURING CONSTRUCTION AND ALL INSTALLED CATCH BASINS. MAINTAIN PROTECTION UNTIL TRIBUTARY SURFACES ARE STABILIZED.
- ALL LOCATIONS OF EXISTING UTILITIES SHOWN HEREON HAVE BEEN ESTABLISHED BY FIELD SURVEY OR OBTAINED FROM AVAILABLE RECORDS AND SHOULD THEREFORE BE CONSIDERED APPROXIMATE ONLY AND NOT NECESSARILY COMPLETE. FIELD VERIFY LOCATION AND DEPTH OF ALL UTILITIES IN AREA OF EXCAVATION AND NOTIFY ENGINEER OF ANY DISCREPANCIES TWO WEEKS PRIOR TO PERFORMING ANY TEMP. SHORING OR EXCAVATION WORK.
- COORDINATE ALL UTILITY INTERRUPTIONS WITH AFFECTED FACILITY OWNERS. PROVIDE MINIMUM 2 WEEKS ADVANCE NOTICE OF SERVICE INTERRUPTIONS.
- COORDINATE ALL UTILITY DEMOLITION WITH CONSTRUCTION OF NEW SYSTEMS. TEMPORARILY MAINTAIN EXISTING UTILITY SYSTEMS AS REQUIRED TO CONVEY FLOWS FROM PORTIONS OF SITE OUTSIDE CONSTRUCTION AREAS AND PROVIDE TEMPORARY BYPASS AND PUMPING SYSTEMS AS REQUIRED BY CONTRACTOR'S OPERATIONS AND OWNER'S USE OF FACILITIES.
- PROVIDE ALL REQUIRED MONITORING, TESTING, REPORTING, AND ALL OTHER COMPLIANCE MEASURES AS NECESSARY TO MEET PROJECT PERMIT COVERAGE REQUIREMENTS.
- ADDITIONAL EROSION CONTROL MEASURES MAY BE REQUIRED BY THE INSPECTOR.

**Cut and Fill Quantity Estimate**

NOTE: QUANTITIES NOTED ARE APPROXIMATE AND ARE TO BE USED FOR MUNICIPAL PERMITTING ONLY. CONTRACTOR IS TO PERFORM THEIR OWN QUANTITY TAKE-OFFS BASED ON THE CONTRACT DOCUMENTS.  
 CUT: ±5 CY  
 FILL: ±40 CY

**TESC General Notes**

- THE IMPLEMENTATION OF THESE TESC PLANS AND THE CONSTRUCTION, MAINTENANCE, REPLACEMENT, AND UPGRADING OF TESC FACILITIES IS THE RESPONSIBILITY OF THE APPLICANT/CONTRACTOR UNTIL ALL CONSTRUCTION IS COMPLETED AND APPROVED, VEGETATION/LANDSCAPING IS ESTABLISHED AND THE ENTIRE SITE IS STABILIZED.
- THE BOUNDARIES OF THE CLEARING LIMITS SHALL BE CLEARLY MARKED IN THE FIELD PRIOR TO CONSTRUCTION. DURING THE CONSTRUCTION PERIOD, NO DISTURBANCE BEYOND THE CLEARING LIMITS SHALL BE PERMITTED. THE MARKING SHALL BE MAINTAINED BY THE APPLICANT/CONTRACTOR FOR THE DURATION OF CONSTRUCTION.
- THE TESC FACILITIES SHOWN ON THIS PLAN SHALL BE CONSTRUCTED PRIOR TO AND/OR IN CONJUNCTION WITH ALL CLEARING AND GRADING ACTIVITIES, AND IN SUCH A MANNER AS TO ENSURE THAT SEDIMENT AND SEDIMENT LADEN WATER DO NOT ENTER THE DRAINAGE SYSTEM OR ROADWAYS, OR VIOLATE APPLICABLE WATER STANDARDS.
- THE TESC FACILITIES SHOWN ON THIS PLAN ARE THE MINIMUM REQUIREMENTS FOR ANTICIPATED SITE CONDITIONS. DURING THE CONSTRUCTION PERIOD, TESC FACILITIES SHALL BE UPGRADED AS NEEDED FOR UNEXPECTED STORM EVENTS AND TO ENSURE THAT SEDIMENT AND SEDIMENT-LADEN WATER DOES NOT LEAVE THE SITE.
- THE CESCL, CPESC, OR ESC LEAD SHALL BE IDENTIFIED IN THE SWPPP AND SHALL BE ONSITE OR ON CALL AT ALL TIMES.
- THE CESCL, CPESC, OR ESC LEAD MUST BE KNOWLEDGEABLE IN THE PRINCIPLES AND PRACTICES OF EROSION AND SEDIMENT CONTROL AND HAVE THE SKILLS TO ASSESS:
  - SITE CONDITIONS AND CONSTRUCTION ACTIVITIES THAT COULD IMPACT THE QUALITY OF STORMWATER.
  - EFFECTIVENESS OF EROSION AND SEDIMENT CONTROL MEASURES USED TO CONTROL THE QUALITY OF STORMWATER DISCHARGES.
- THE CESCL, CPESC, OR ESC LEAD MUST EXAMINE STORMWATER VISUALLY FOR THE PRESENCE OF SUSPENDED SEDIMENT, TURBIDITY, DISCOLORATION, AND OIL SHEEN AND EVALUATE THE EFFECTIVENESS OF BMPs TO DETERMINE IF IT IS NECESSARY TO INSTALL, MAINTAIN, OR REPAIR BMPs.
- THE CESCL, CPESC, OR ESC LEAD MUST INSPECT ALL AREAS DISTURBED BY CONSTRUCTION ACTIVITIES, ALL BMPs, AND ALL STORMWATER DISCHARGE POINTS AT LEAST ONCE EVERY CALENDAR WEEK AND WITHIN 24 HOURS OF ANY DISCHARGE FROM THE SITE. (INDIVIDUAL DISCHARGE EVENTS THAT LAST MORE THAN ONE DAY DO NOT REQUIRE DAILY INSPECTIONS). THE CESCL OR INSPECTOR MAY REDUCE THE INSPECTION FREQUENCY FOR TEMPORARILY STABILIZED, INACTIVE SITES TO ONCE EVERY CALENDAR MONTH.
- CONSTRUCTION SITE OPERATORS MUST CORRECT ANY PROBLEMS IDENTIFIED BY THE CESCL, CPESC, OR ESC LEAD BY:
  - REVIEWING THE SWPPP FOR COMPLIANCE WITH THE 13 CONSTRUCTION SWPPP ELEMENTS AND MAKING APPROPRIATE REVISIONS WITHIN 7 DAYS OF THE INSPECTION.
  - FULLY IMPLEMENT AND MAINTAIN APPROPRIATE SOURCE CONTROL AND/OR TREATMENT BMPs AS SOON AS POSSIBLE BUT CORRECTING THE PROBLEM WITHIN 10 DAYS.
  - DOCUMENTING BMP IMPLEMENTATION AND MAINTENANCE IN THE SITE LOG BOOK. (REQUIRED FOR SITES LARGER THAN 1 ACRE BUT RECOMMENDED FOR ALL SITES).
- AT NO TIME SHALL MORE THAN ONE FOOT OF SEDIMENT BE ALLOWED TO ACCUMULATE WITHIN A CATCH BASIN SEDIMENT TRAP.
- ALL CATCH BASINS AND CONVEYANCE LINES SHALL BE CLEANED PRIOR TO PAVING. THE CLEANING OPERATION SHALL NOT FLUSH SEDIMENT-LADEN WATER INTO THE DOWNSTREAM SYSTEM.
- STABILIZED CONSTRUCTION ENTRANCES SHALL BE INSTALLED AT THE BEGINNING OF CONSTRUCTION AND MAINTAINED FOR THE DURATION OF THE PROJECT. ADDITIONAL MEASURES MAY BE REQUIRED TO ENSURE THAT ALL PAVED AREAS ARE KEPT CLEAN FOR THE DURATION OF THE PROJECT.
- ANY POLLUTANTS, CHEMICALS, LIQUID PRODUCTS, AND OTHER MATERIALS THAT HAVE THE POTENTIAL TO POSE A THREAT TO HUMAN HEALTH OR THE ENVIRONMENT WILL BE COVERED, CONTAINED, AND PROTECTED FROM VANDALISM. ALL SUCH PRODUCTS SHALL BE KEPT UNDER COVER IN A SECURE LOCATION ON-SITE.

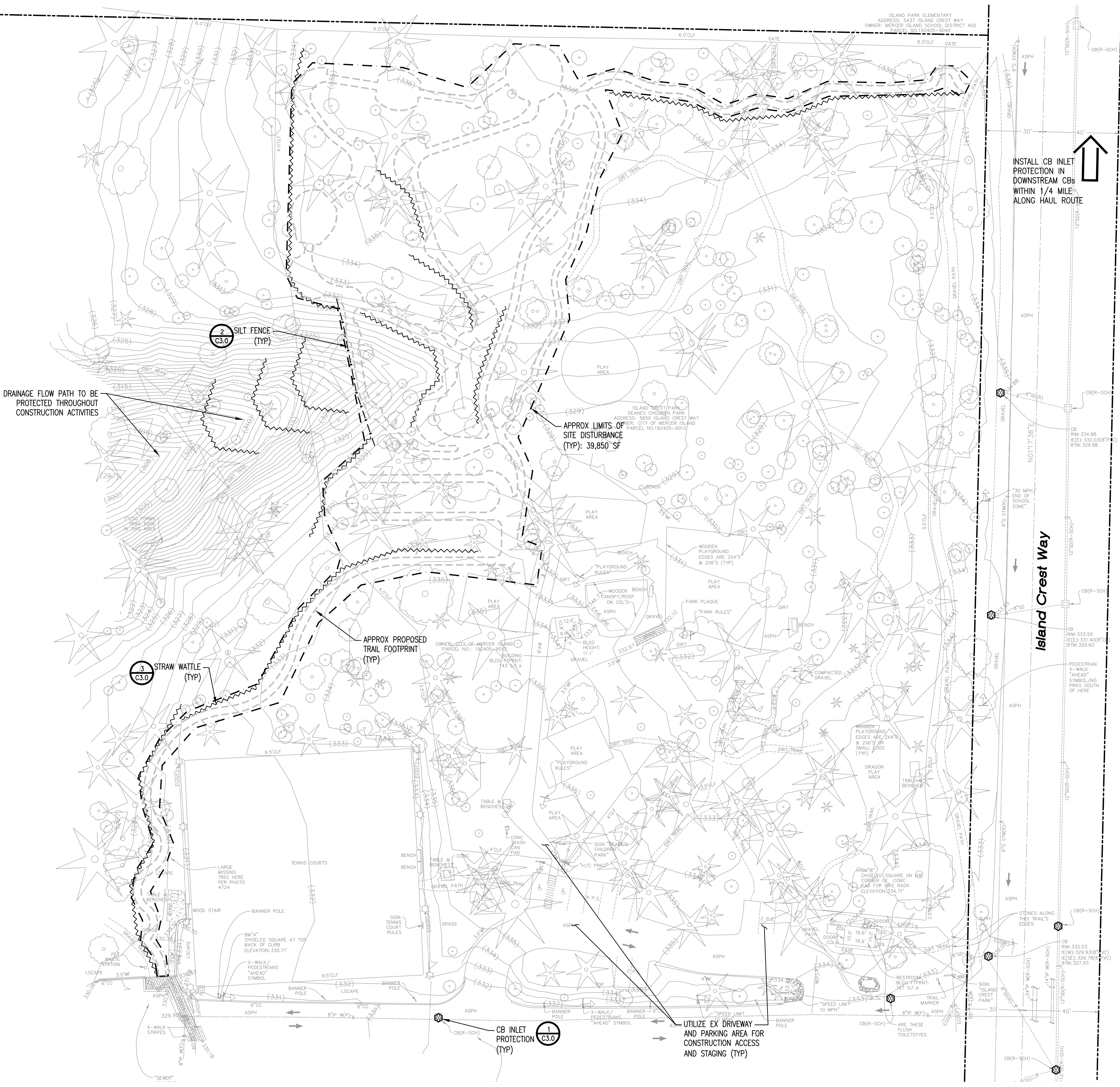

INSTALL CB INLET PROTECTION IN DOWNSTREAM CATCH BASINS WITHIN 1/4 MILE ALONG HAUL ROUTE

DRAINAGE FLOW PATH TO BE PROTECTED THROUGHOUT CONSTRUCTION ACTIVITIES

APPROX LIMITS OF SITE DISTURBANCE (TYP): 39,850 SF

APPROX PROPOSED TRAIL FOOTPRINT (TYP)

UTILIZE EX DRIVEWAY AND PARKING AREA FOR CONSTRUCTION ACCESS AND STAGING (TYP)

File: C:\Users\Steve.Hatzenbuehler\OneDrive - Station10 Engineering - Station10\Projects\23\23004 - MI Bike Skills Park\PLANS\BKEPRK-1-1-23\TESC SITE DEMO.dwg ID: Steve.Hatzenbuehler Date: 28-Jun-23 4:01:10pm



**Datum**  
 NAVD 88

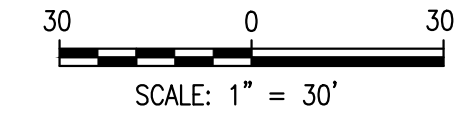

**Legend**

- COMPACTED DIRT SURFACING
- WOOD DECKING
- DISPERSION IN VEGETATION

**Proposed Surface Areas**

- COMPACTED DIRT SURFACING NEW/REPLACED HARD SURFACING: 10,554 SF
  - WOOD DECKING NOT CONSIDERED HARD SURFACING: 919 SF
- NET INCREASE IN IMPERVIOUS SURFACING: 0 SF

**Notes**

1. SEE BELOW FOR GENERAL NOTES.
2. MAINTAIN ALL EXISTING UTILITY SERVICES DURING CONSTRUCTION. PROVIDE TEMPORARY SERVICES AND ALL BYPASS SYSTEMS, INCLUDING PUMPING, AS NECESSARY TO ACCOMPLISH NEW CONSTRUCTION AND MINIMIZE SERVICE INTERRUPTIONS.
3. COORDINATE ALL UTILITY INTERRUPTIONS W/ AFFECTED FACILITY OWNERS. PROVIDE MIN 2 WEEKS ADVANCE NOTICE OF ANY SERVICE INTERRUPTION.
4. ADJUST ALL NEW AND EX UTILITY CASTINGS TO FINAL FINISHED GRADE PRIOR TO FINAL PAVING/PLANTING.
5. TAKE THE NECESSARY PRECAUTIONS DURING TRENCH EXCAVATION TO PROTECT EXISTING UTILITIES FROM DAMAGE AND SETTLEMENT.
6. PERFORM SUBGRADE PREPARATION IN ACCORDANCE WITH THE REQUIREMENTS AND RECOMMENDATIONS OF GEOTECHNICAL REPORT PREPARED FOR THIS PROJECT.
7. GRADE ALL AREAS TO PROVIDE DRAINAGE AWAY FROM THE TRAILS DOWN-SLOPE INTO THE ADJACENT VEGETATION.
8. COORDINATE GRADING AROUND EXISTING FEATURES WITH OWNER. NOTIFY ENGINEER AND OWNER OF ANY DISCREPANCIES.
9. COORDINATE AND VERIFY LAYOUT OF ALL NEW WALKWAYS WITH OWNER PRIOR TO PERFORMING ANY PREPARATION OR INSTALLATION WORK.
10. FINE GRADE AREAS TO DIRECT DRAINAGE TO VEGETATED AREAS DOWN-SLOPE.
11. THE SITE IS SUBJECT TO RESTRICTIONS ON GRADING AND CONSTRUCTION ACTIVITIES DURING THE WET SEASON. LAND DISTURBING ACTIVITIES ARE PROHIBITED FROM OCTOBER 1st TO APRIL 30th UNLESS A WET SEASON CONSTRUCTION REQUEST IS SUBMITTED, REVIEWED, AND A WET SEASON CONSTRUCTION APPROVAL LETTER IS GRANTED BY THE CITY OF MERCER ISLAND.

**General Notes**

1. ALL WORK SHALL CONFORM TO THE MERCER ISLAND STORMWATER DRAINAGE GUIDELINES AND THE 2014 DOE MANUAL.
2. A COPY OF THE APPROVED PLAN MUST BE ON SITE WHENEVER CONSTRUCTION IS IN PROGRESS.
3. ERRORS AND OMISSIONS ON THE PERMITTED PLANS MUST BE CORRECTED BY THE ENGINEER AND APPROVED BY THE CITY OF MERCER ISLAND.
4. ALL PERMITS REQUIRED FOR WORK WITHIN THE PUBLIC RIGHT OF WAY MUST BE OBTAINED PRIOR TO THE START OF CONSTRUCTION.
5. PRIOR TO THE START OF CONSTRUCTION WITHIN THE RIGHT OF WAY, THE PERMITTEE SHALL SCHEDULE AND ATTEND A PRECONSTRUCTION MEETING WITH THE CITY OF MERCER ISLAND.
6. PERMITTEE SHALL CONTACT MERCER ISLAND INSPECTOR A MINIMUM OF 2 BUSINESS DAYS PRIOR TO NEEDING AN INSPECTION.
7. ALL DAMAGE TO CITY INFRASTRUCTURE CAUSED BY THE CONSTRUCTION SHALL BE REPAIRED AS REQUIRED BY THE CITY OF MERCER ISLAND.
8. LIMITS OF PAVEMENT RESTORATION IN THE PUBLIC RIGHT OF WAY SHALL BE DETERMINED IN THE FIELD BY THE CITY OF MERCER ISLAND STREET USE INSPECTOR PRIOR TO THE PAVEMENT RESTORATION.
9. SURVEYING AND STAKING OF ALL IMPROVEMENTS IN THE PUBLIC RIGHT OF WAY SHALL BE COMPLETED PRIOR TO CONSTRUCTION.
10. IF AN EXISTING CURB IS TO BE REMOVED AND REPLACED IN THE SAME LOCATION, THE PERMITTEE SHALL PROVIDE THE STREET USE INSPECTOR A PLAN WITH EXISTING FLOW LINE AND TOP OF CURB ELEVATIONS IDENTIFIED. PERMITTEE TO STAKE THE LOCATION OF THE EXISTING CURB PRIOR TO DEMOLITION.
11. THE PERMITTEE SHALL BE RESPONSIBLE FOR REFERENCING AND REPLACING ALL MONUMENTS THAT MAY BE DISTURBED, DESTROYED OR REMOVED BY THE PROJECT AND SHALL FILE AN APPLICATION FOR PERMIT TO REMOVE OR DESTROY A SURVEY MONUMENT WITH THE WASHINGTON STATE DEPARTMENT OF NATURAL RESOURCES, PURSUANT TO RCW 58.24.040(8).
12. THE PERMITTEE SHALL NOTIFY THE FIRE DEPARTMENT DISPATCHER AT LEAST TWENTY-FOUR (24) HOURS IN ADVANCE OF ALL WATER SERVICE INTERRUPTIONS, HYDRANT SHUTOFFS, AND STREET CLOSURES OR OTHER ACCESS BLOCKAGE. THE PERMITTEE SHALL ALSO NOTIFY THE DISPATCHER OF ALL NEW, RELOCATED, OR ELIMINATED HYDRANTS RESULTING FROM THIS WORK.
13. THE PERMITTEE SHALL LOCATE AND PROTECT ALL CASTINGS AND UTILITIES DURING CONSTRUCTION.
14. THE PERMITTEE SHALL CONTACT THE UNDERGROUND UTILITIES LOCATOR SERVICE (1-800-424-5555 OR 811) AT LEAST ONE WEEK PRIOR TO CONSTRUCTION.
15. IT IS THE SOLE RESPONSIBILITY OF THE PERMITTEE TO VERIFY THE ACCURACY OF ALL UTILITY LOCATIONS SHOWN AND TO FURTHER DISCOVER AND AVOID ANY OTHER UTILITIES NOT SHOWN WHICH MAY BE AFFECTED BY THE IMPLEMENTATION OF THIS PLAN.
16. THE PERMITTEE SHALL ADJUST ALL EXISTING MANHOLE RIMS, DRAINAGE STRUCTURE LIDS, VALVE BOXES, AND UTILITY ACCESS STRUCTURES TO FINISHED GRADE WITHIN AREAS AFFECTED BY THE PROPOSED IMPROVEMENTS.
17. UTILITY SERVICE CONNECTIONS SHOWN ON THIS PLAN REQUIRE SEPARATE PERMITS AND ARE TO BE MAINTAINED PRIVATELY.
18. THE PERMITTEE SHALL PROVIDE FOR ALL TESTING AS REQUIRED BY THE MERCER ISLAND STREET USE INSPECTOR.
19. BACKFILL MATERIAL USED IN PUBLIC RIGHT-OF-WAY SHALL MEET STANDARD SPECIFICATIONS AND SHALL BE APPROVED BY CITY OF MERCER ISLAND.
20. INSPECTION AND ACCEPTANCE OF ALL WORK IN THE PUBLIC RIGHT-OF-WAY SHALL BE DONE BY REPRESENTATIVES OF THE CITY OF MERCER ISLAND. IT SHALL BE THE PERMITTEE'S RESPONSIBILITY TO COORDINATE AND SCHEDULE APPROPRIATE INSPECTIONS ALLOWING FOR PROPER ADVANCE NOTICE. THE INSPECTOR MAY REQUIRE REMOVAL AND RECONSTRUCTION OF ANY ITEMS PLACED IN THE RIGHT OF WAY THAT DO NOT MEET CITY STANDARDS OR THAT WERE CONSTRUCTED WITHOUT APPROPRIATE INSPECTIONS.
21. THE PERMITTEE SHALL PROVIDE AND MAINTAIN TEMPORARY EROSION CONTROL AND SEDIMENTATION COLLECTION FACILITIES TO ENSURE THAT SEDIMENT-LADEN WATER DOES NOT ENTER THE NATURAL OR PUBLIC DRAINAGE SYSTEM. AS CONSTRUCTION PROGRESSES AND UNEXPECTED (SEASONAL) CONDITIONS DICTATE, ADDITIONAL CONTROL FACILITIES MAY BE REQUIRED. DURING THE COURSE OF CONSTRUCTION IT SHALL BE THE OBLIGATION AND RESPONSIBILITY OF THE PERMITTEE TO ADDRESS ANY NEW CONDITIONS THAT MAY BE CREATED BY THE PERMITTEE'S ACTIVITIES AND TO PROVIDE ADDITIONAL FACILITIES THAT MAY BE NEEDED TO PROTECT ADJACENT PROPERTIES.
22. THE PERMITTEE SHALL KEEP ALL PAVED SURFACES IN THE RIGHT OF WAY CLEAN BY SWEEPING.
23. AN APPROVED TRAFFIC CONTROL PLAN WILL BE REQUIRED FOR ALL PUBLIC STREETS PRIOR TO BEGINNING CONSTRUCTION.



Call Before  
 You Dig!  
**811**

Rev #	Date	Description
Sta10 Project #:		23004
Submittal:		Permit

**Bike Skills Area at Deane's Children's Park**  
 5701 Island Crest Way  
 Mercer Island, WA 98040

Design:	SEH
Drafting:	--
Checked:	SEH
Date:	6/28/23

**Drainage Plan**

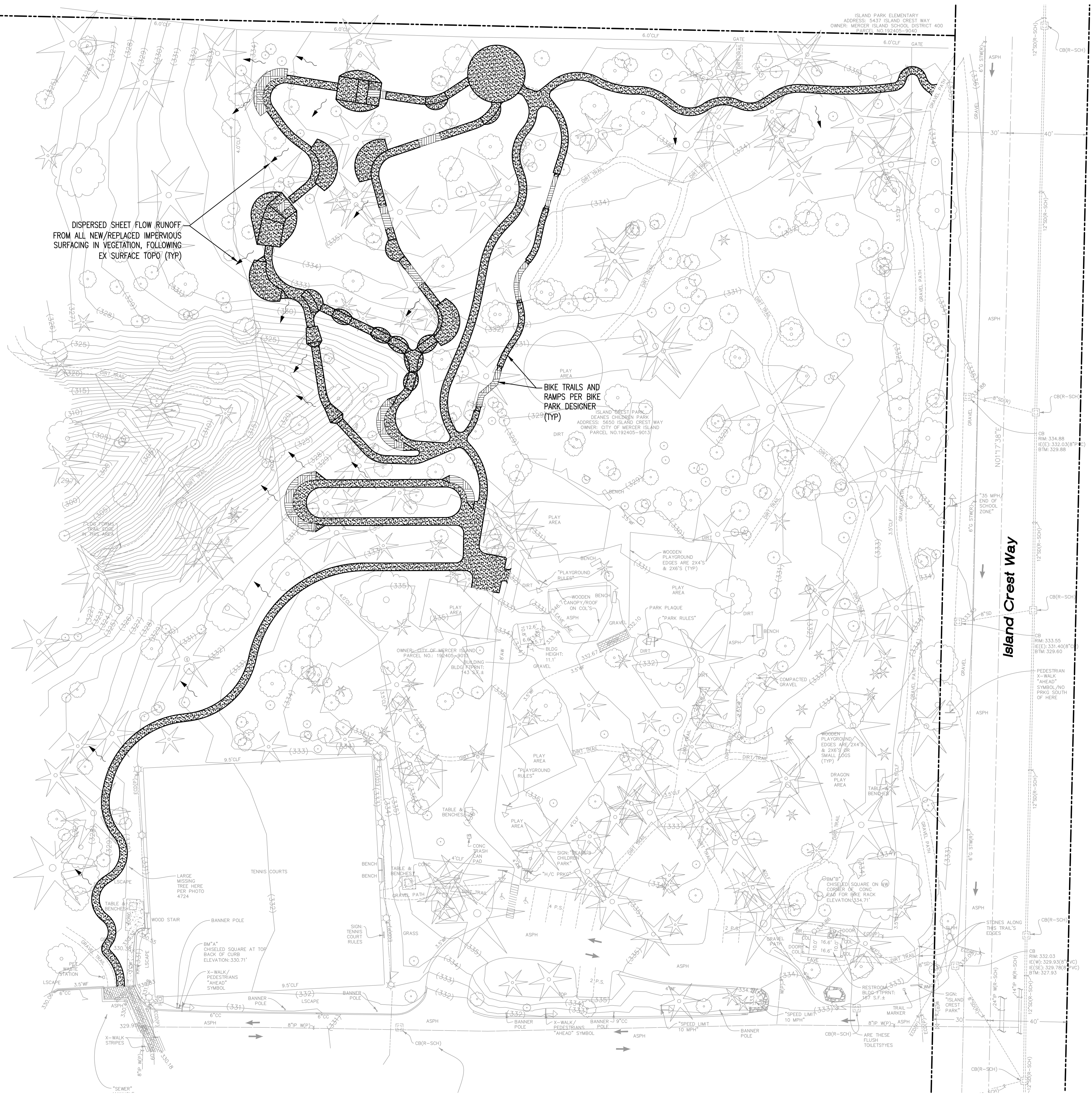



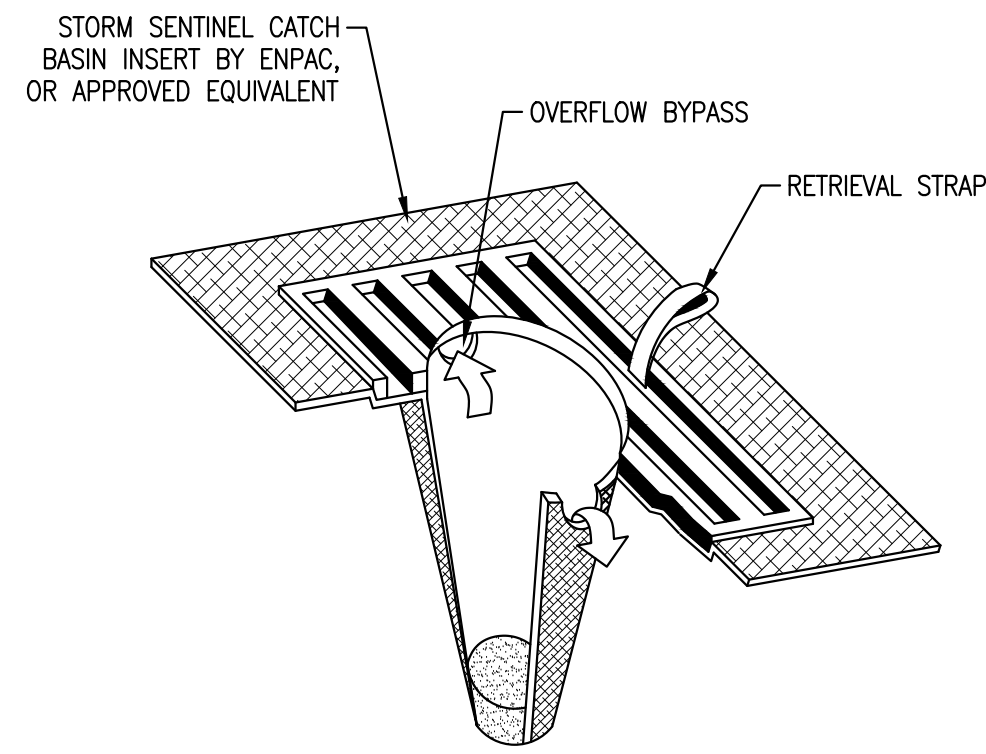

1 CB Inlet Protection  
C3.0 NTS

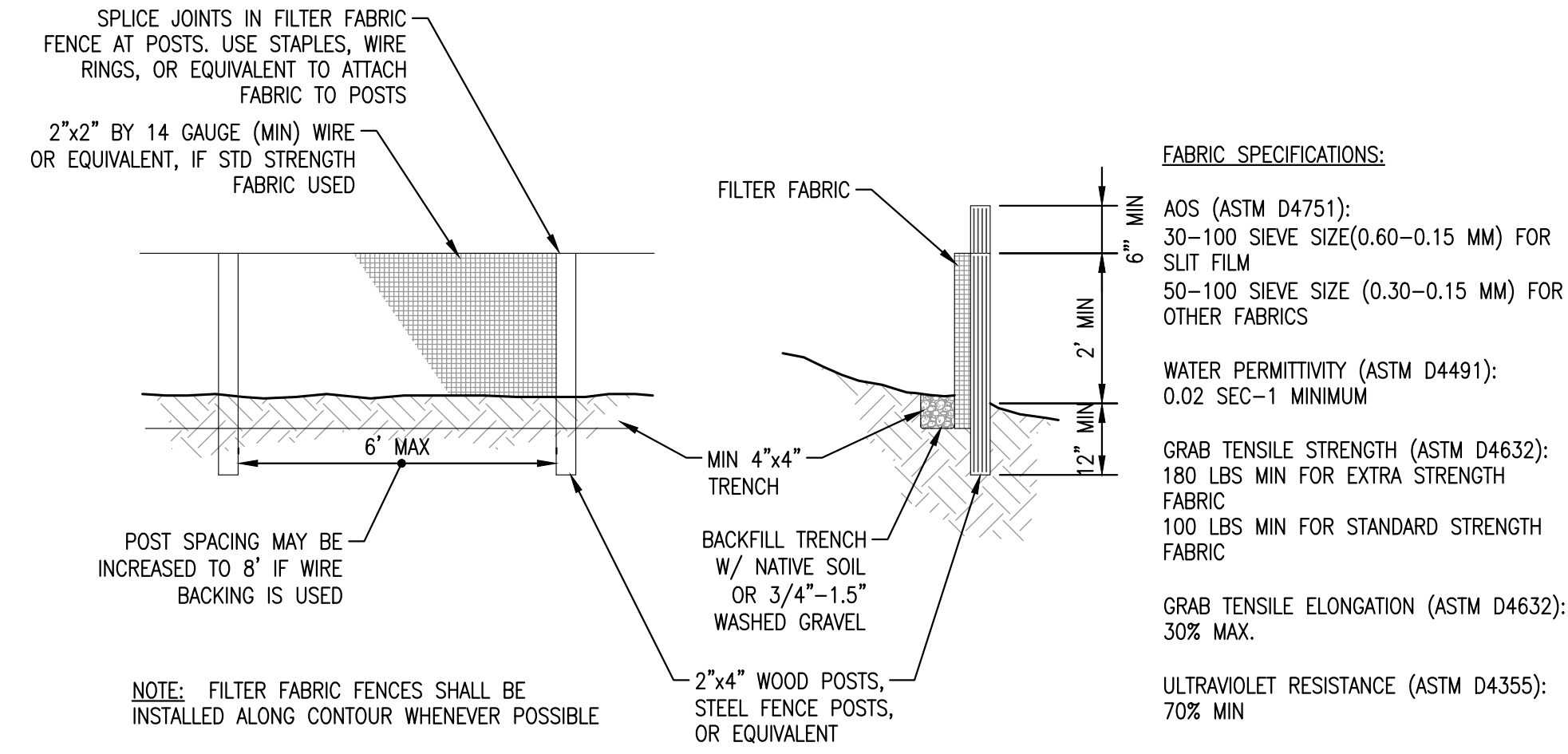

2 Silt Fence  
C3.0 NTS

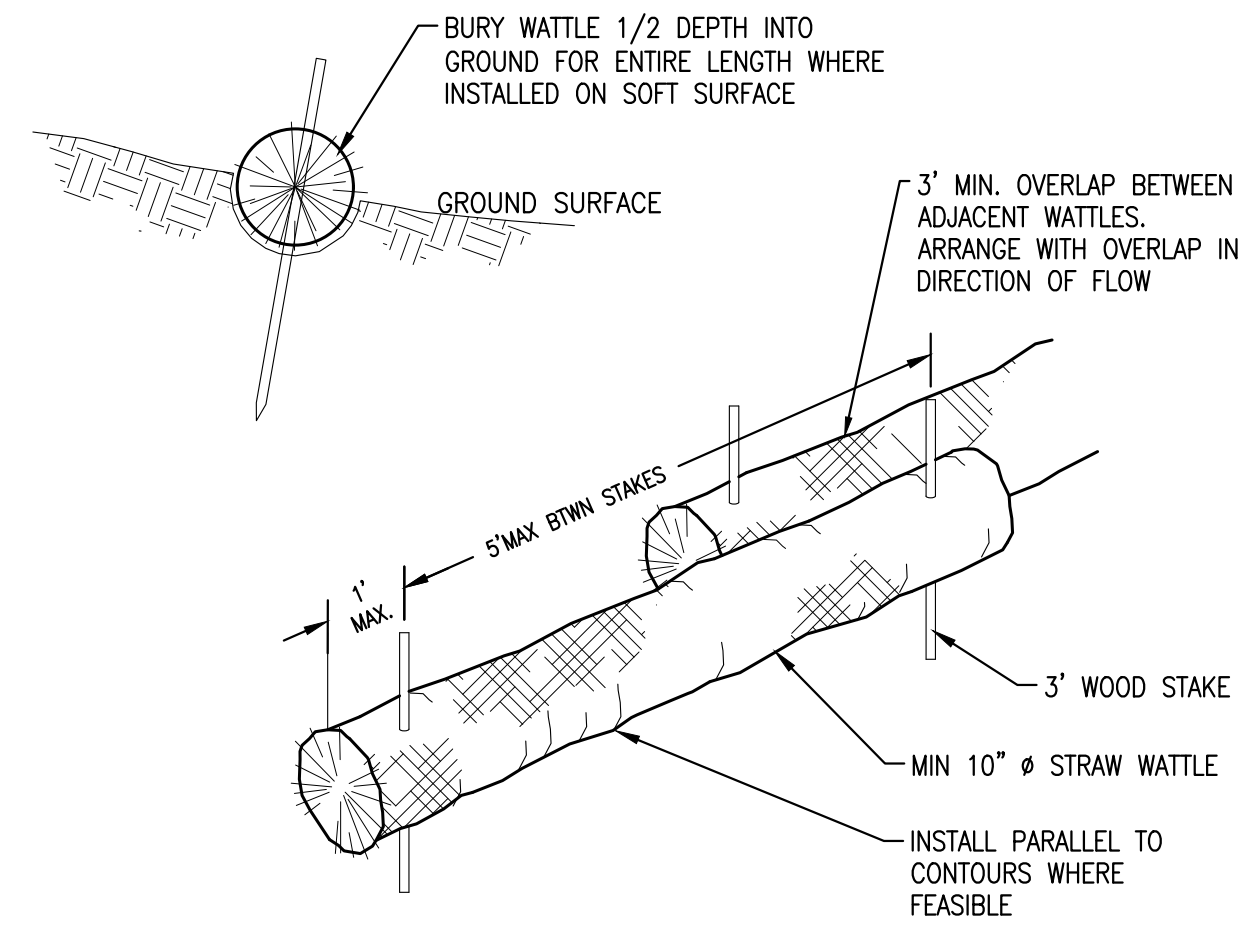

3 Straw Wattle  
C3.0 NTS



6/28/23

Call Before  
You Dig!  
**811**

Rev # Date Description

Sta10 Project #: 23004  
Submittal: Permit

**Bike Skills Area at Deane's Children's Park**  
5701 Island Crest Way  
Mercer Island, WA 98040

Design: SEH  
Drafting: --  
Checked: SEH  
Date: 6/28/23

**Site Details**

Sheet:

**C3.0**